

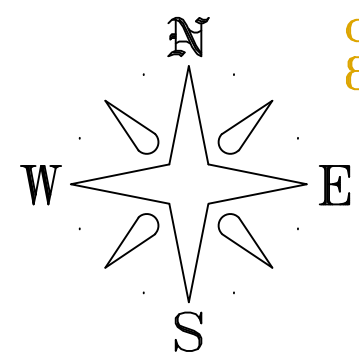

SD HWY #139 from
SD HWY #20 to SD
HWY# 212 to be
chip sealed.
86,103 Sq. Yds.



LAKE KAMPESKA

Key:
2016 Chip Seal 
TOTAL Chip Seal
Sq. Yards  849,834

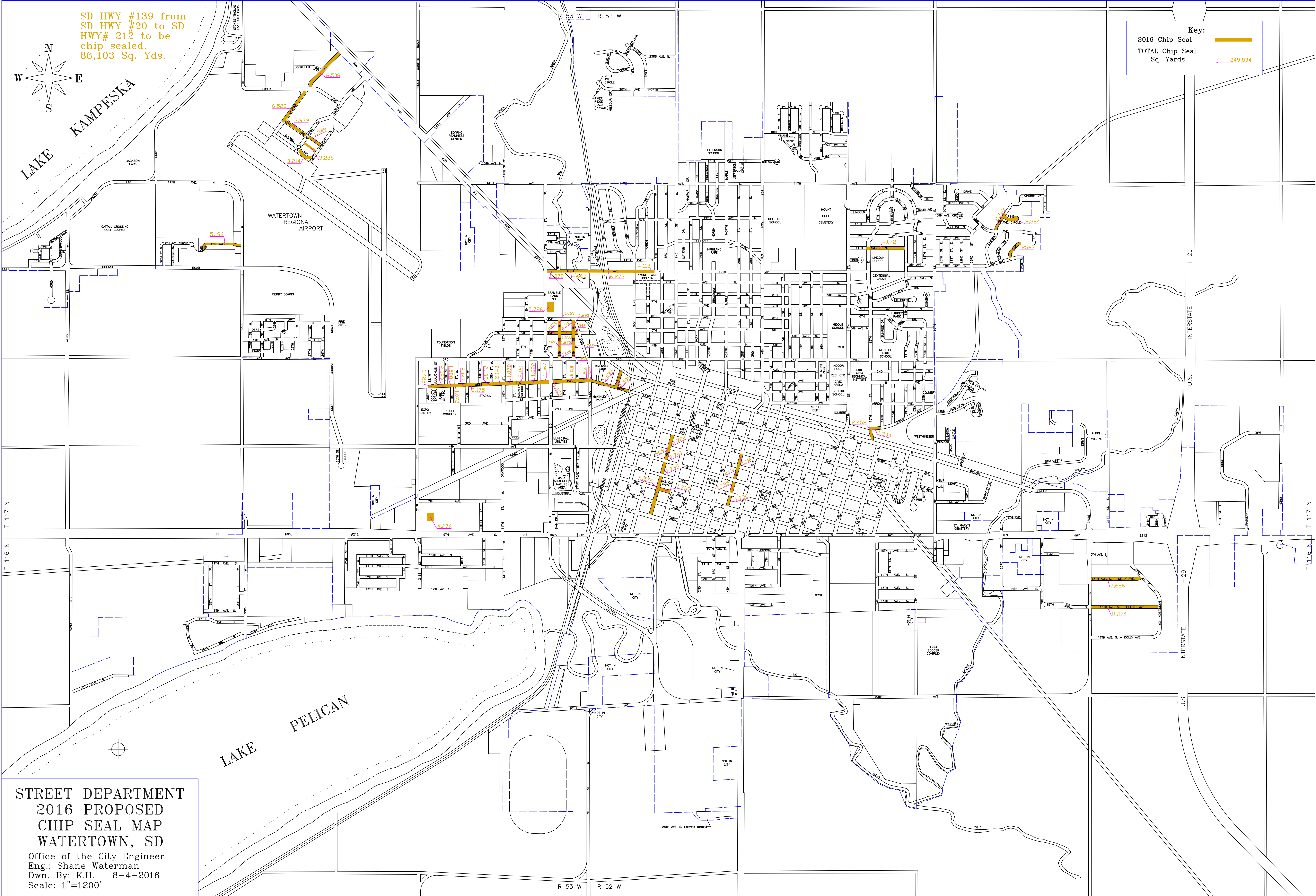

STREET DEPARTMENT
2016 PROPOSED
CHIP SEAL MAP
WATERTOWN, SD
Office of the City Engineer
Eng.: Shane Waterman
Dwn. By: K.H., 8-4-2016
Scale: 1"=1200'