

**Key:**

PROPOSED 2016 Mill & Overlay Square Yards	68,443
PROPOSED 2016 Microsurfacing Square Yards	22,514

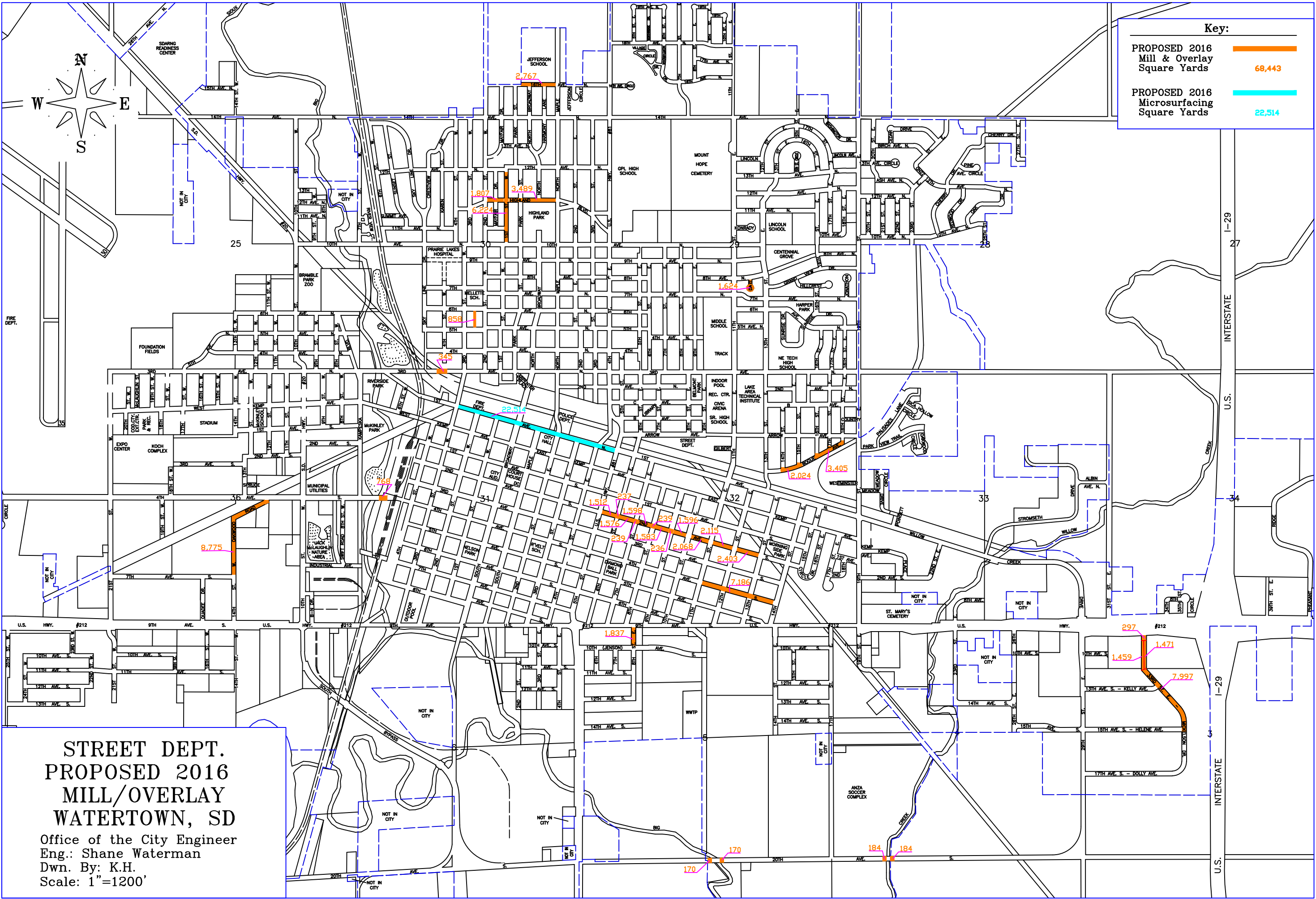

**STREET DEPT.  
PROPOSED 2016  
MILL/OVERLAY  
WATERTOWN, SD**

Office of the City Engineer  
Eng.: Shane Waterman  
Dwn. By: K.H.  
Scale: 1"=1200'